

Food & Beverage

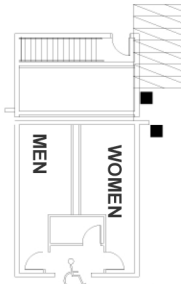

Food & Beverage

SIMON'S AGENCY, INC. #1441

M 6, M 5, M 4, M 3, MR 2, MR 1

20' Reserved 1449, Reserved 1448, 1447, Boncura 1446, Collection 1445, SkyCom 1444

20' Revenue 1438, Special 1437, TELCOR 1436, McKesson 1435, Macro Helix 1434, United Collec 1433, Fort Hill 1432, Billing Tree 1431, Financial 1430

HCFS, Inc 1428, Sunbelt 1427, Eide Bailly 1426, Strategic 1425, 20' Reserved 1423, 20' Paymerang 1421

Newmark 1350, Beckers 1349, Emergency 1348, LiveVox 1347, Reserved 1346, Reserved 1345, VEP Health 1344, Inworks 1343, Colburn Hill 1341

20' Healthcare 1338, Cirius Group 1337, SwervePay 1336, 1335, Chetu Inc. 1334, Reserved 1333, MRO Corpo 1332, AccuReg 1330

HCS Health 1328, The PFM 1327, Organization 1326, Reserved 1325, 20' Reserved 1323, 20' Reserved 1321, 20' 1319

20' Orbograph 1249, American 1248, RonDento 1247, The CMI 1246, Virtual Medic 1245, Reserved 1244, IRCODER.CO 1242, Panacea 1241

20' Vyne Medical 1238, 20' RevCycle+ 1236, 20' OSG / 1234, 20' BKD 1232, 20' CarePayment 1230

20' Professional 1227, 20' BBVA 1225, 20' One 1223, 20' Voya 1221, 20' Fund 1219

Professional 1215, Concure 1214, ProCred 1212, mCritical 1211, Salud Reve 1210, 20' Resource 1208, The Halley 1205, 20' Global 1201

20' 1149, 20' Reserved 1147, 40' RevClaims 1047, 20' GeBBS Healthcare Solutions 1044, 20' R1 RCM 1041

20' Bolder Healthcare Solutions 1038, 20' Healthcare IP 1035, 40' PFS Group 1030

40' Experian Health 1025, 20' HEALTHCARE PAYMENT SPECIALIST 1022, 20' MedData, Inc. 1019

20' Reserved 1016, 20' Cleverley + Associates 1013, 20' U.S. Bank/Elavon 1010, 20' 1107, 20' Reserved 1007, 20' JTS Health 1104, 20' Reserved 1004, 20' Craneware, Inc. 1001

30' VisiQuate 948, 30' ClearBalance 848, 60' HFMA Career Development Booth 841

Caravan 939, 30' HBSCS 936, 20' Smart Source 838, 20' Vee 836, 20' eSolutions, Inc. 833, 20' Human Arc 830

20' Coding 927, 20' Intermedix 925, 20' accesshealth 827, 20' Zebu 825, 20' Avadyne Health 822, 20' GE Healthcare 819

Xtend Healthcare, A Navient Company 815, 30' Jvion 811, 30' Patientco 807, 20' HealthPay24 804, 20' Recondo Technology 801

20' CBCS 749, Reserved 748, Angiology 747, 20' M*Modal 745, 20' Reserved 743, 20' Crowe 741, 20' State 649, PowerWellm 648, 20' CareCredit 646, Global Credit 645, ChartMaxx by 643, 20' Allscripts 641

20' PNC 738, 20' MCG Health 736, Reserved 735, Softek 734, 20' Accuity 732, 20' Core 730, 20' CBIZ KA 638, 20' MedeAnalytic 636, 20' Medical 634, 20' Healogics 632, 20' Physicians 630

20' Alpha II 727, Cyberscien 726, Workday 725, FISCAL 724, Valida 723, Subway 722, Claim Tech 721, 20' OVAG 719, 20' Cantata 627, IC Systeme 626, Progressive 625, 20' Harris 623, QueueLogix 621, 20' Alltran 619

20' MedAssist 716, DIVDAT 715, Washington 714, 20' Navigant 712, 20' BESLER 709, GHX - Global 707, 20' RSG Inc. 705, 20' Revenue 703, 20' Sherloq 701, 20' Priority 616, 40' Commerce Bank 612, 20' DCS Global 609, 20' AccessOne 607, 20' ProAssurance 605, 20' Zotec 603, 20' Strata 601

30' MiraMed 448, 30' 444, 20' Capio Partners 441

40' Salucro Healthcare Solutions 436, 50' Parallon 430, 20' Ontario Systems 427, 20' The SSI Group, LLC 424, 40' ZirMed 419

30' nThrive 415, 30' TransUnion 411, 30' Premier, Inc. 407

50' Change Healthcare 402

Sutter Physi 339, 20' Health 337, AIM Speci 239, Noble Syste 238, Wolters 237, 20' TruBridge 234, 30' Optum 230

40' RevSpring 225, 20' Nuance 222, 20' Cerner Corporation 219, 20' Simplee 216, 50' 3M Health Information Systems 210, 20' GLOBAL 307, 20' Kaufman Hall 207

20' Ontario Systems 427, 20' The SSI Group, LLC 424, 40' ZirMed 419, 30' nThrive 415, 30' TransUnion 411, 30' Premier, Inc. 407

50' Change Healthcare 402

20' Apex 139, Dynafios 138, OnOpera 137, Millenium 136, Health Data 135, FMS Inc. 134, Medic al 133, Ovati on 132, PT Soluti 131, EOS Health 130, 20' PMMC 128, 20' MDsave 126, 20' Reserved 124, 20' Harris & 122, Ameri can 121, 20' Holliday & 119, RSM US LLP 117, 20' AMTdirect 115, 20' Reserved 113, 20' Healthcare 111, 20' IBM Watson 109, 20' Jacobus 107, Merch ant 104

